

Roborock Zeo Lite

Washer Dryer User Manual

Read this user manual carefully before using this product and store it properly for future reference.



Contents

English	03
Deutsch	26

03	Safety Instructions
07	Instructions for Use
08	Product Overview
08	Connecting to the App
08	Installation Requirements
09	Installation
11	How to Use Detergent
12	Control Panel
15	Features
16	Program Table
17	Maintenance
18	Specifications
21	FAQ
22	Troubleshooting
25	Circuit Diagram

Safety Instructions

Please read the following safety instructions carefully, and install and use the machine as instructed.

- Only use the product in accordance with the User Manual. Any loss or damage caused by improper use will be borne by the user.
- Roborock's retailers assume responsibility only for losses resulting from installation performed by authorized retailers' technicians, excluding losses arising from incorrect installation by other people.
- Roborock and its retailers disclaim all liability for indirect, incidental, or consequential damages resulting from the use, misuse, or inability to use this product. This disclaimer does not affect any statutory rights that may not be disclaimed under applicable law.
- This product is not intended for use by persons (including children) with reduced physical, sensory or mental capabilities, or lack of experience and knowledge, unless they have been given supervision or instruction concerning use of the product by a person responsible for their safety (CB).
- Children should be supervised to ensure that they do not play with the appliance.
- This product can be used by children aged from 8 years and above and persons with reduced physical, sensory or mental capabilities or lack of experience and knowledge if they have been given supervision or instruction concerning use of the product in a safe way and understand the hazards involved. Children shall not play with the product. Cleaning and user maintenance shall not be made by children without supervision (EU).
- Children of less than 3 years should be kept away unless continuously supervised (EU).
- The removed packaging materials should be disposed of in time to keep out of reach of children or prevent children from swallowing them.
- Do not place any heavy objects, exothermic appliances and objects that may leak on the machine, or it may be damaged.
- Do not operate the machine when flammable gases (such as coal gas) leak.
- The room must be well ventilated to avoid the gases flowing from the machine from igniting other substances in the room, including open flames.
- To avoid the danger arising from resetting the thermal circuit breaker by accident, do not power on the machine during reset.
- Do not pile up combustibles and sundries (such as cotton waste) around the machine.
- There are glass parts in the machine. If they are damaged by accident, please dispose of or replace them in time to avoid injury.
- When you pull out the detergent drawer to add detergent, please be careful not to bump into or get scratched by its hard corners.
- If the machine is transported in an environment where the temperature is below 0°C in winter, put it at room temperature for 3 hours before turning it on.
- Whenever the machine is to be transported, reinstall its transit bolts to prevent damage to it during transportation.
- When handling the machine, please grip the base of the packaging cabinet instead of the protruding parts of the machine, especially its control panel or door.
- Please do not touch any hot parts of the machine during or at the end of the drying process, or burns may occur.
- Do not change the power cord without permission, or accidents may happen.
- If the machine makes any abnormal noise or emits a burnt smell, please stop using it immediately and unplug it.
- The tumble dryer is not to be used if industrial chemicals have been used for cleaning.
- The lint trap has to be cleaned frequently, if applicable.
- Lint must not be allowed to accumulate around the tumble dryer.
- Do not dry unwashed items in the tumble dryer.
- Items that have been soiled with substances such as cooking oil, acetone, alcohol, petrol, kerosene, spot removers, turpentine, waxes and wax removers should be washed in hot water with an extra amount of detergent before being dried in the tumble dryer.
- Items such as foam rubber (latex foam), shower caps, waterproof textiles, rubber backed articles and clothes or pillows fitted with foam rubber pads should not be dried in the tumble dryer.

Safety Instructions

- Fabric softeners, or similar products, should be used as specified by the fabric softener instructions.
- Remove all objects from pockets such as lighters and matches.
- The appliance must not be installed behind a lockable door, a sliding door or a door with a hinge on the opposite side to that of the tumble dryer, in such a way that a full opening of the tumble dryer door is restricted.
- The rated capacity and dry capacity of this product are 10.0 kg and 6.0 kg respectively and its operating water pressure is 0.1-1.0 MPa.
- Roborock disclaims all liability for indirect, incidental, or consequential damages resulting from the use, misuse, or inability to use this product. This disclaimer does not affect any statutory rights that may not be disclaimed under applicable law.
- This appliance is intended to be used in household and similar applications such as:
 - staff kitchen areas in shops, offices and other working environments;
 - farm houses;
 - by clients in hotels, motels and other residential type environments;
 - bed and breakfast type environments;
 - areas for communal use in blocks of flats or in laundrettes.

WARNING

- If the supply cord is damaged, it must be replaced by the manufacturer, its service agent or similarly qualified persons in order to avoid a hazard.
- The new hose-sets supplied with the appliance are to be used and that old hose-sets should not be reused.
- Never stop a tumble dryer before the end of the drying cycle unless all items are quickly removed and spread out so that the heat is dissipated.
- The appliance must not be supplied through an external switching device, such as a timer, or connected to a circuit that is regularly switched on and off by a utility.
- Most spare parts of your appliance are available for a minimum of 10 years after placing the last appliance on the market. If you have any questions, please contact our customer service at:

Email: support@roborock-eu.com

Official website: <https://support.roborock.com/hc/de>

Address: Roborock Germany GmbH, Harffstr.47,40591 Düsseldorf

Warning!

Risk of electric shock.

Never try to repair an appliance which is defective or presumed to be defective. You may put your own and future users' lives in danger. Only authorised specialists are allowed to carry out this repair work.

Improper repair will void the warranty and subsequent damages can't be recognised!

Safety Instructions

EU Declaration of Conformity

We Nanjing Roborock Innovation Technology Co.,Ltd. hereby, declares that this equipment is in compliance with the applicable Directives and European Norms, and amendments. The full text of the EU declaration of conformity is available at the following internet address: <https://global.roborock.com/pages/compliance>

WiFi Specification

Service	Protocol	Frequency Range	Max. Output Power
WiFi	802.11b/g/n	2400-2483.5 MHz	≤20dBm

WEEE Information

Correct Disposal of this product. This marking indicates that this product should not be disposed with other household wastes throughout the EU. To prevent possible harm to the environment or human health from uncontrolled waste disposal, recycle it responsibly to promote the sustainable reuse of material resources. To return your used device, please use the return and collection systems or contact the retailer where the product was purchased. They can take this product for environmental safe recycling.



International Symbols Explanation

⊕ – PROTECTIVE EARTH (Protective Ground) symbol [symbol IEC 60417-5019 (2009-02)]

Safety Instructions

⚠ Warning Hazardous or unsafe acts that may cause personal injury or property damage.

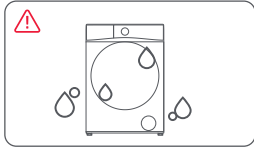

Keep the machine away from rain or severe humidity. Use it at temperatures between 0 and 40°C.

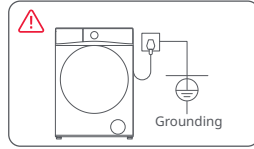

Plug the machine into a 230V~/50Hz three-prong outlet, which should be correctly and reliably grounded. No extension cord is allowed.

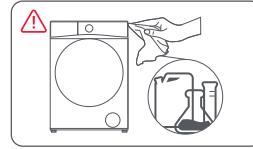

Do not wipe the body and parts of the machine with flammable, explosive, and soluble chemicals, or put them into the machine.

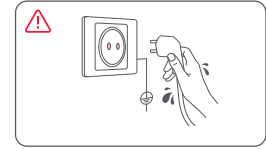

Power off the machine before cleaning or performing maintenance. Never plug or unplug the machine with wet hands.

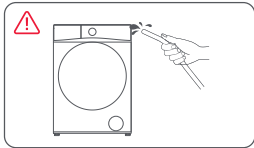

Do not spray water or other liquids onto the machine.

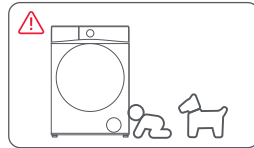

Be sure to watch out for children or pets to prevent them from getting into the drum, and keep them away from the machine while it is running.

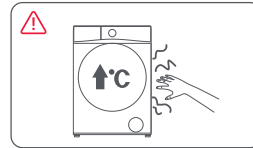

When the machine is running, the door glass may get hot. Please do not touch the glass, or allow pets to touch it.

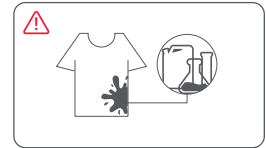

Do not wash or dry clothes stained with gasoline, alcohol, petroleum, benzene, thinner or other chemicals.

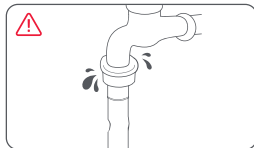

Connect the machine to the tap with a new water inlet hose, and replace the hose in time in case of damage or leakage.

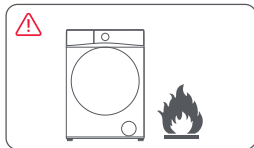

Keep lit cigarettes, candles, or other fire sources as well as volatiles and inflammables away from the machine.

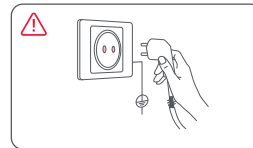

To avoid danger, the damaged power cord of the machine must be replaced by a professional sent by the service department of the manufacturer.

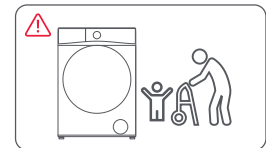

Do not allow children or the elderly and the vulnerable to use the machine on their own.

Instructions for Use

First Use

- The machine is subject to water-based tests before leaving the factory. It is normal that a small amount of water remains in the drum, gasket, and on the door glass.
- For the first time of use, please make sure to install the machine correctly and run a drum clean with clean water.
- There may be smells given off by rubber parts at first, but they will gradually disappear after the machine is used a few more times.

Notes on Washing

Do Not Wash

- Please check the clothing care labels carefully before washing and perform as instructed.
- Stubborn stains should be handled manually before washing.
- For delicate and expensive clothing, and small items like socks, please put clothing into laundry bags.
- For wool or silk clothing that should be washed with a specific detergent, be sure to turn off Auto Dosing and put the detergent into the drum manually.
- Do not put too many clothes into the drum above the highest washing capacity, or they may not be fully cleaned.
- It is recommended to separate your clothes by color before washing to avoid color bleeding.
- The machine may not work properly during the spin cycle if washing one piece of clothing or a few pieces of heavy or highly absorbent clothing due to uneven weight distribution. It is recommended to add more items to the cycle.
- It is recommended to open the door for ventilation after washing every time to prevent the drum from growing mold or giving off odors.

Notes on Drying

Drum Drying

- Please check the clothing care labels carefully before drying and perform as instructed.
- It is recommended not to dry too many clothes in one load, or they may not be fully dried.
- It is recommended to dry large items such as bed sheets and curtains separately for the optimum drying effect.

- Please keep the tap on during drying to avoid inadequate water supply or low water pressure, which may degrade the drying effect.
- During drying, the remaining time displayed is estimated time, which may slightly vary with the weight of the clothes and the Dry program due to smart adjustment.
- The drying effect is subject to various factors, such as the selected Wash+Dry/Dry program as well as the material and amount of clothes.
- Please do not tap "Start/Pause" and open the door during drying, or the clothes may not be fully dried or the machine may malfunction after the drying is resumed.
- Clothes may stretch or shrink to varying degrees after drying depending on their materials.
- After drying ends, the door cannot be opened immediately until it has cooled to a temperature that is safe to touch.
- The RPM will automatically increase in the programs under the Wash+Dry mode. Protect delicate clothing and do not select this mode when washing and drying delicate clothing.

Do Not Dry

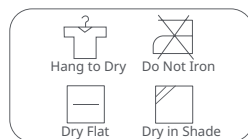

Clothes marked with the symbols above cannot be drum dried, or they may be damaged.



Do not drum dry clothes made of special materials, such as printed clothing, rubber, leather and fur lining.

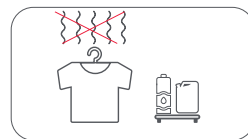

Do not drum dry clothes that have been treated with chemicals such as bleach or degreaser.

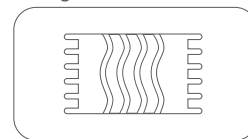

Do not drum dry items that are easy to expand, such as a sleeping bag, duvet and large blanket.

Product Overview

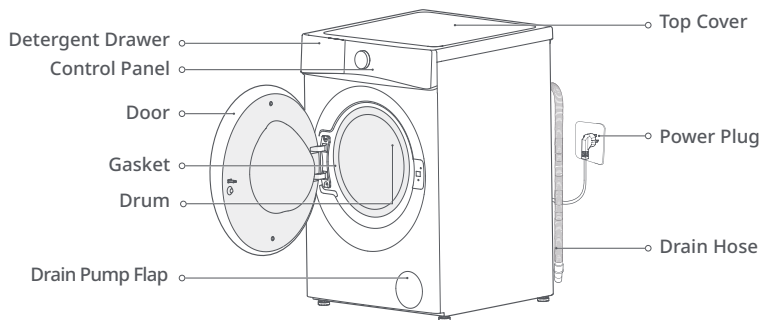

Accessories

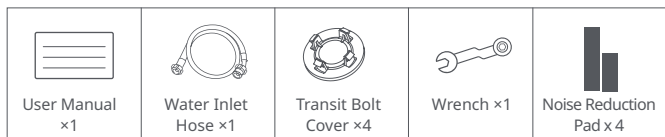

Check all accessories shown in the picture above. If the machine is damaged or the accessories are missing during transportation, please contact the dealer.

Connecting to the App

1. Scan the QR code to download and install the Roborock app.
2. Open the app, and tap "Add Device" or "+" to add an appliance.
3. Follow the instructions in the app to complete the connection.
4. The WiFi (📶) lamp is always on, indicating that the appliance is connected to the network.



Scan to download the APP

Note: Tap and hold the "Rinse" button for 3 seconds until the WiFi lamp flashes slowly. The WiFi will reset and the machine will be restored to factory settings.

Installation Requirements

Installation Environment

- Place the washing machine on a level, firm, and non-slip surface. Do not install it on a base or shelf.
- Keep the washing machine in a well-ventilated place away from direct sunlight and freezing weather.
- The working environment temperature should be 0°C - 40°C.
- Keep the washing machine away from heat sources such as charcoal fires or gas stoves.

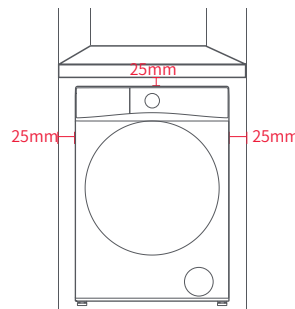

Top: $\geq 25\text{mm}$
Sides: $\geq 25\text{mm}$
Front: $\geq 550\text{mm}$
Rear: $\geq 50\text{mm}$

Power Supply

- Connect the washing machine to a power supply (230V~/50Hz) which should be correctly and reliably grounded.
- Make sure the power cord is not pinched by any objects.

Water Supply

- The washing machine requires a water pressure of 0.1MPa to 1.0MPa. Water pressure lower than 0.1MPa may cause abnormal water inflow. In this case, the washing machine may not work properly and will display the prompt [E1].
- Place the washing machine as close to the faucet as possible; Check the inlet valve and all connections of the faucet for leakage.
- Do not connect the washing machine to a hot water source.

Installation

Installing the noise reduction pads (optional)

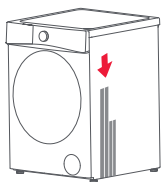

1. Find four noise reduction pads on foam supporting board.

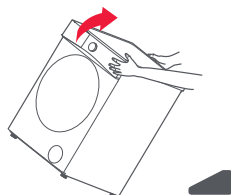

2. Carefully lay the washing machine down on its rear side with leveling feet toward the operator. Be careful not to break the glass parts (control panel and door) of the machine.

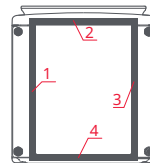

3. Remove the double-sided adhesive protective film from noise reduction pads and then paste pads around the bottom of machine (two longer pads in position 1 and 3, two shorter pads in position 2 and 4).

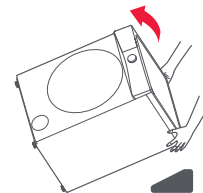

4. Finally set the machine upright again.

Removing the transit bolts

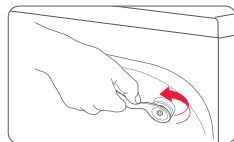
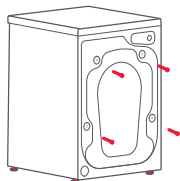

1. Unscrew the four transit bolts by turning them counterclockwise using a wrench (Which is attached to the foam supporting board).

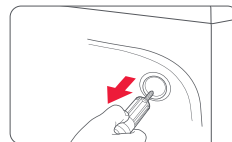

2. Pull out the bolts and keep them properly (for use during transportation).

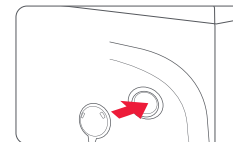

3. Cover the transit bolt holes with transit bolt covers.

Installation

Adjusting the leveling feet

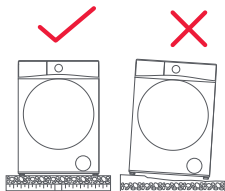

1. Press the top cover of the washing machine with both hands. If the machine shakes, please adjust the leveling feet.

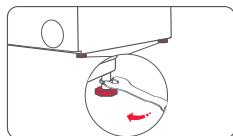

2. Loosen the leveling foot bolts by turning to the left with a wrench.



3. Rotate the leveling feet to obtain desired height.

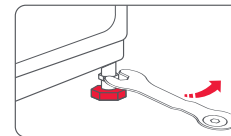

4. Tighten the leveling foot bolts to ensure the four leveling feet are level.

Connecting the water inlet hose

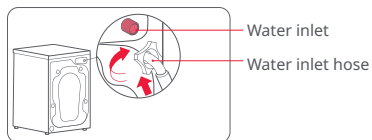

1. Align the water inlet hose to the water inlet and tighten it.



2. Connect the water inlet hose to the water system (3/4 " faucet) and make sure that everything is connected firmly.

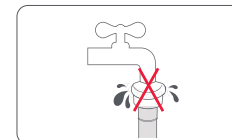

3. Check the connections for leakage. In case of leakage, please check if the above requirements are met and the steps are followed.

Installation

Connecting the drain hose

a. When fixed to a sink

The end of drain hose should be fixed firmly with a sling no higher than 1.2m from the ground, and its end should not be immersed in water.

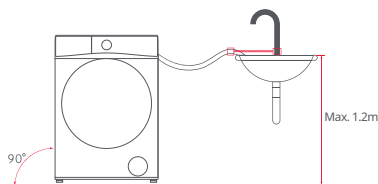

b. When connected to a branch tailpiece

The end of drain hose should be connected to a branch tailpiece, with its highest point no lower than 0.65m from the ground.

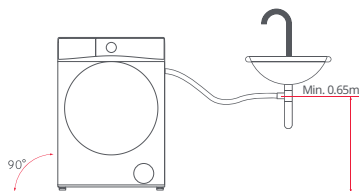

c. When inserted directly into a floor drain

To prevent gravity drainage, the drain hose was securely fastened with clips before leaving the factory. To ensure proper drainage performance, please do not remove the clips or fix the drain hose at a height lower than 0.65m from the ground.

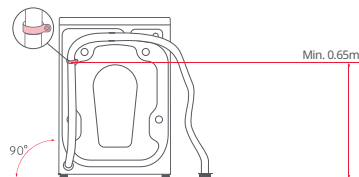

Notes:

- Connect the drain hose with one of the three installation methods above.
- Do not remove fixing clips from the drain hose, or drainage may fail.
- To prevent scalding, do not touch the discharged hot laundry water during high-temperature washing.
- If the drain hose is too long, consider cutting it shorter. Do not forcibly shove it back into the washing machine. Otherwise, it may cause abnormal noise.
- Do not bend the drain hose, or drainage may fail.
- If an extension pipe is required, make sure the extension pipe is less than 1.5m in length and 0.2m in height to avoid poor drainage.

How to Use Detergent

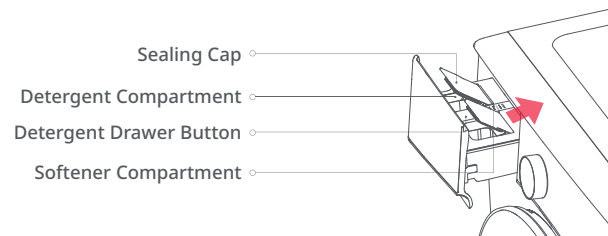

Auto Dosing

- Do not add detergent and softener above the MAX line, and lock the sealing caps after addition.
- Add detergent and softener before operating the machine. When there is not enough detergent/softener in the detergent drawer, the detergent/softener light on the control panel will keep flashing as a reminder to add detergent/softener. If you ignore the reminder, the clothes will be washed with clean water after the detergent/softener is used up.
- The Auto Dosing can be enabled/disabled on the control panel or in the app.
- The dose of detergent/softener can be adjusted in the app.

Manual Dispense Mode

- If you choose to add detergent manually, be sure to turn off Auto Dosing, or the clothes may not be fully rinsed.
- If you use washing powder/disinfectant/laundry pods, put them into the drum directly before washing and turn off Auto Dosing.
- If you use wool/silk-specific detergents, please put them into the drum as instructed and turn off Auto Dosing.

Notes:

- It is recommended to use low-sudsing detergent for front-load washers.
- Do not pull the detergent drawer out while the machine is running, or the dispense function may not work properly or water may overflow.
- When the machine is not used for a long time and the detergent becomes lumpy or sticky, dilute it with a small amount of warm water to prevent clogging.
- Do not put cleaning agents other than detergent/softener into the detergent drawer, or the dispense function may not work properly.

Control Panel

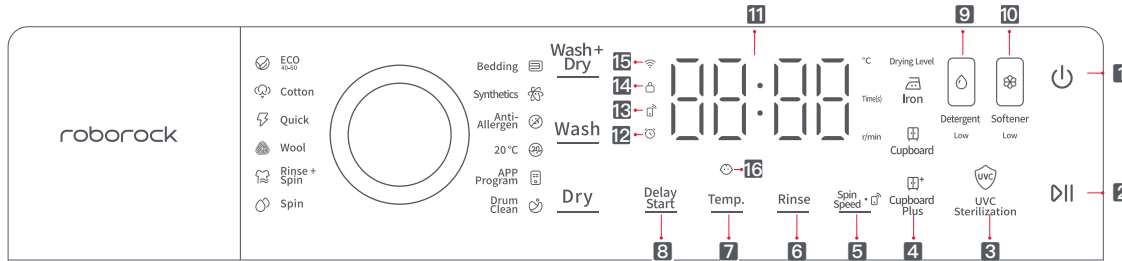

1 Power (⏻)

Tap to turn the machine on, and tap and hold for 2 seconds to turn the machine off. The machine will automatically shut down if left inactive for 10 minutes.

2 Start/Pause (⏸)

Tap to start/pause a program. Tap during running to unlock the door and add clothes mid-cycle. When the water level or temperature is too high to open the door, the Door Lock Lamp will flash, with a beep as well as "Lock" and the remaining time displayed alternately on the screen.

3 UVC Sterilization (UVC)

Tap to enable/disable UVC sterilization. When the lamp stays on, it indicates that the UVC sterilization is enabled. It is not available for all programs.

4 Iron/Cupboard/Cupboard Plus: Tap Iron/Cupboard/Cupboard Plus to choose a dryness level, and this setting defaults to Cupboard/Cupboard Plus.

5 Spin Speed:

After selecting a program, tap to select the desired spin speed from No Spin/400/600/800/1000/1200/1400 RPM. Some programs may limit the RPM for clothing material protection.

6 Rinse: After selecting a program, tap to select a desired number of rinses from 1/2/3/4/5. Some programs may have a fixed rinse time(s).

7 Temp.: After selecting a program, tap to select the desired water temperature from cold(--)/20°C/30°C/40°C/60°C/90°C. Some programs may limit the water temperature for clothing material protection.

8 Delay Start: After selecting a program, tap to increase the time after which the program will start by 30 minutes on the display (max 24 hours). Tap the Start/Pause button to confirm the Delay Start, and the program will start when the schedule time counts down to zero. Then the time displayed will be switched to the estimated time of the selected program.

Control Panel

9 Detergent Lamp (🧼)

Tap to enable/disable Detergent Auto Dosing. When it stays on, it indicates that the Detergent Auto Dosing is enabled and there is enough detergent; when the Low icon lights up, it indicates that there is insufficient detergent; and when it is off, it indicates that the Detergent Auto Dosing is disabled. Auto dosing is enabled by default.

10 Softener Lamp (🌀)

Tap to enable/disable Softener Auto Dosing. When it stays on, it indicates that the Softener Auto Dosing is enabled and there is enough softener; when the Low icon lights up, it indicates that there is insufficient softener; and when it is off, it indicates that the softener Auto Dosing is disabled. Auto dosing is enabled by default.

11 Display: It shows different statuses of programs, including the remaining time, delay start time, error code, temp., rinses, and RPM.

12 Delay Start Lamp (⏸)

When it stays on, it indicates that the wait time is being set; when it flashes, it indicates that the time is counting down; and when it is off, it indicates that there is no delay start or the program is running.

13 Remote Control On Indicator Light (📶)

When the icon lights up, the remote control is on, and when it goes off, the remote control is off.

14 Door Lock Lamp (🔒)

When it stays on, it indicates that the door is locked; when it flashes, it indicates that the door cannot be opened at the moment; and when it is off, it indicates that the door is unlocked.

15 WiFi Lamp (📶)

When it stays on, it indicates that the machine is connected to the network and can be remotely controlled with the app; when it slowly flashes, it indicates that the machine is waiting for network connection; when it quickly flashes, it indicates that the machine is connecting to the network; and when it is off, it indicates disconnection.

16 Child Lock Lamp (🙅)

When the machine is running, tap and hold Temp. and Rinse for 3 seconds to enable/disable the child lock. If the lamp stays on, it indicates that the feature is enabled, and all buttons except Power and the said combination buttons of child lock are disabled; when it is off, it indicates that the feature is disabled.

Control Panel

Program	Description
Eco 40-60	Eco 40-60 program is able to clean normally soiled cotton laundry declared to be washable at 40°C or 60°C , together in the same cycle, and that this program is used to assess the compliance with the EU ecodesign legislation.
Cotton	Suitable for fabrics such as cotton and linen.
Synthetics	Suitable for synthetic clothing.
Wool	Recommended for 2kg or less of machine washable wool fabric (it is optimal to use special detergent for wool fabric).
20°C	Washing brightly colored clothes for better protection of colors.
APP Program	You can add special laundry programs in the Roborock app to "APP Program" for quick access on the control panel, with "Intensive" by default.
Bedding	Recommended for 5kg or less of four-piece bedding, curtains, and other large fabrics.
Anti-Allergen	90°C high-temperature washing, with 60°C healthy washing by default. Multiple rinses to remove common allergens such as dust mites and pet dander.
Quick	Quick wash for a small amount of lightly-soiled clothes. * Recommended for 1kg or less of clothes.
Rinse+Spin	Recommended for separate rinsing or spinning of 10kg or less of clothes.
Spin	Recommended for 10kg or less of clothes that need spinning only.
Drum Clean	Rinses the drum at high temperature with special detergent (as needed). Note: Do not add clothes.

Drying Level Description

Iron	The clothes contain a little moisture after drying and are ready for ironing.
Cupboard	The clothes are skin-friendly and ready for immediate wearing after drying.
Cupboard Plus	The clothes are thoroughly dry and can be folded up and put away after drying.

Operating Procedure

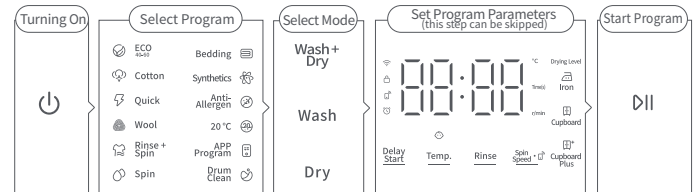

Notes:

- Program parameter settings such as "Delay Start" and "Temp." can only be adjusted after a program is selected.
- When the machine is running, touch any program icon on the screen, and the drum lamp will automatically switch on.

Modes

- **Wash+Dry:** Wash, and then dry.
- **Wash:** Wash only, without drying.
- **Dry:** Dry only, without washing.

Features

Mid-Cycle Adding

Tap Start/Pause to add clothes during mid-cycle. This feature is only available when the water temperature is less than 50°C, the water level is below the door viewing window, and the machine is not performing drying.

Remote Control

Press and hold the "Spin Speed" button for 3 seconds to activate remote control. Then you can control the washer remotely through the Roborock app.

Prerequisites:

- The washer has been connected to your WiFi network.
- The washer has been connected to the Roborock app.
- The washer door has been closed.

Deactivate Remote Control:

- When the washer is not operating, press the "Power" button to deactivate the remote control;
- When the washer is operating, press the "Pause" button, and the remote control will be deactivated automatically once the door is unlocked;
- When the washer is paused with its door locked, press and hold the "Spin Speed" button for 3 seconds to deactivate the remote control;
- Press and hold the "Power" button to deactivate the remote control.

Emergency Door Opening

In case of an emergency, pull the emergency pull ring to open the door, and then reset the pull ring after the door is opened. (Note: The emergency pull ring is on the lower right of the machine, and must not be used during a regular wash cycle. Before opening the door, please make sure all the water is drained out and be careful not to get burned).

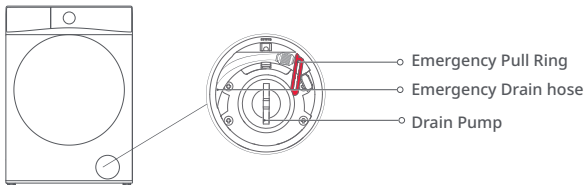

Power Outage Memory

If there is a power outage when the machine is running, the machine will resume the current cycle after the power comes back on. During a power outage, please do not force the door open. If you need to do so, enable "Emergency Door Opening".

Door Lock/Unlock

After the Wash program is started, the door is automatically locked, and the door lock lamp is always on. After the program is paused/ended, the door is automatically unlocked with the door lock lamp off when the door opening conditions are met. Unlocking is unavailable when the water level or temperature is high during running. If you do need to open the door, enable "Emergency Door Opening".

Wool Care-Blue



The wool drying cycle of this machine has been tested and approved by The Woolmark Company. The cycle is suitable to dry wool garments which are labelled "hand wash" provided that the garments are washed in a Woolmark endorsed hand washing cycle and dried according to the instructions issued by the manufacturer of this machine. M2315.

Wool Care-Green



The wool wash cycle of this machine has been tested and approved by The Woolmark Company for the washing of wool garments labelled as "hand wash" provided that the products are washed according to the instructions on the garment label and those issued by the manufacturer of this washing machine. M2309.

Program Table

	Name	Capacity ≤ (kg)	Temperature (°C)						Rinse (Time(s))					Spin (r/min)						Drying Level			Auto Dosing	
			Cold	20	30	40	60	90	1	2	3	4	5	No Spin	400	600	800	1000	1200	1400	Iron	Cupboard	Cupboard Plus	Detergent
Wash	Eco 40-60	10	/	/	/	/	○	/	/	○	/	/	/	/	/	/	/	/	○	/	/	/	○	○
	Cotton	10	√	√	√	○	√	√	√	○	√	√	√	√	√	√	√	○	√	/	/	/	○	○
	Synthetics	4	√	√	○	√	√	/	√	○	√	√	/	√	√	√	○	√	/	/	/	/	○	○
	20°C	5	/	○	/	/	/	/	√	○	√	√	√	√	√	√	○	/	/	/	/	/	○	○
	Quick	1	○	√	√	√	/	/	○	√	/	/	/	√	√	○	√	/	/	/	/	/	○	○
	Bedding	5	√	√	√	○	√	/	√	○	√	√	√	√	√	√	○	√	/	/	/	/	○	○
	Anti-Allergen	5	/	/	/	/	○	√	√	√	○	√	√	√	√	√	○	√	/	/	/	/	○	○
	Wool	2	√	√	○	√	/	√	○	√	/	/	/	√	√	○	/	/	/	/	/	/	○	○
	Rinse+Spin	10	/	/	/	/	/	/	○	√	√	/	/	√	√	√	√	○	√	/	/	/	/	○
	Spin	10	/	/	/	/	/	/	/	/	/	/	/	√	√	√	√	○	√	/	/	/	/	/
Drum Clean	-	/	/	/	/	○	√	/	○	/	/	/	/	/	/	○	/	/	/	/	/	/	/	
Wash+Dry	Eco 40-60	6	/	/	/	/	○	/	/	○	/	/	/	/	/	/	/	/	○	/	○	/	○	○
	Cotton	6	√	√	√	○	√	√	√	○	√	√	√	/	/	/	/	√	○	√	○	√	○	○
	Synthetics	3	√	√	○	√	√	/	√	○	√	√	/	/	/	/	√	○	/	√	○	√	○	○
	20°C	5	/	○	/	/	/	/	√	○	√	√	√	/	/	/	/	√	○	√	○	√	○	○
	Quick	1	○	√	√	√	/	/	○	√	/	/	/	/	/	/	/	/	○	√	○	√	○	○
	Bedding	5	√	√	√	○	√	/	√	○	√	√	√	/	/	/	/	√	○	√	○	√	○	○
	Anti-Allergen	5	/	/	/	/	○	√	√	√	○	√	√	/	/	/	/	√	○	√	○	√	○	○
	Wool	1	√	√	○	√	/	/	√	○	√	/	/	/	/	/	○	/	/	/	/	○	/	○
	Rinse+Spin	6	/	/	/	/	/	/	○	√	√	/	/	/	/	/	/	√	○	√	○	√	/	○
	Spin	6	/	/	/	/	/	/	/	/	/	/	/	/	/	/	/	√	○	√	○	√	/	/
Drum Clean	-	/	/	/	/	○	√	/	○	/	/	/	/	/	/	○	/	/	/	/	/	○	/	
Dry	Eco 40-60	6	/	/	/	/	/	/	/	/	/	/	/	/	/	/	/	/	○	/	○	/	/	/
	Cotton	6	/	/	/	/	/	/	/	/	/	/	√	/	/	/	/	○	√	√	○	√	/	/
	Synthetics	3	/	/	/	/	/	/	/	/	/	/	√	/	/	/	√	○	/	√	○	√	/	/
	20°C	5	/	/	/	/	/	/	/	/	/	/	√	/	/	/	/	○	√	√	○	√	/	/
	Quick	1	/	/	/	/	/	/	/	/	/	/	√	/	/	/	/	○	√	○	√	/	/	/
	Bedding	5	/	/	/	/	/	/	/	/	/	/	√	/	/	/	/	○	√	√	○	√	/	/
	Anti-Allergen	5	/	/	/	/	/	/	/	/	/	/	√	/	/	/	/	○	√	√	○	√	/	/
	Wool	1	/	/	/	/	/	/	/	/	/	/	/	/	/	/	/	/	/	/	○	/	/	/
Drum Clean	-	/	/	/	/	/	/	/	/	/	/	/	/	/	/	/	/	/	/	/	/	○	/	

○ means "default", √ means "available", / means "not available", - means "N/A"

* The parameters for each program may vary slightly due to the continuous software development and upgrades.

Maintenance

Body and Gasket (Clean after each use)

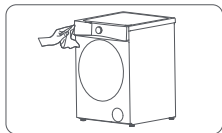

1. Wipe the body with a soft cloth and a detergent that contains no corrosive materials.

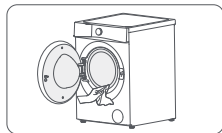

2. Wipe the gasket with a soft cloth, and remove the foreign objects (if any) from the groove.

Detergent Drawer (Clean as needed)

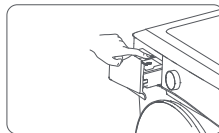

1. Press the detergent drawer button to pull the detergent drawer out. (Be careful not to break the glass panel).

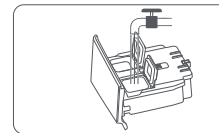

2. Rinse with water, pour off the residual water, wipe the drawer dry, and reinstall it.

Drain Pump Filter Element (Clean monthly)

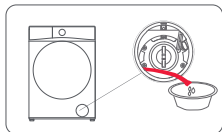

1. Press to open the drain pump flap, and pull the emergency drainpipe to drain the residual water.

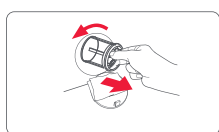

2. Rotate anticlockwise to take the filter element out, and clean the waste on it.

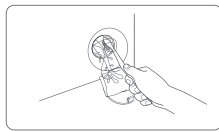

3. Check for and remove any foreign objects from the drain pump.

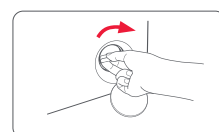

4. Put the filter element back into the drain pump and tighten it, and close the drain pump flap.

Inlet Valve Filter (Clean monthly)

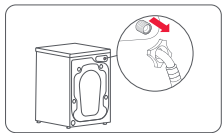

1. Turn off the tap and unscrew the water inlet hose.

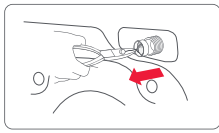

2. Take the inlet valve filter out with needle-nose pliers and rinse it.

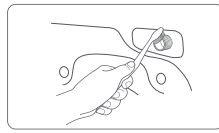

3. Clean the threaded part of the inlet valve with a brush.

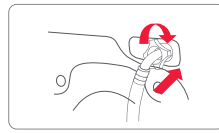

4. Reconnect the water inlet hose to the tap and turn on the tap to check for leakage.

Maintenance

Instructions for Maintenance

- Always unplug the machine before cleaning.
- The disassembled parts must be reinstalled in place, inspected, and tested before use.
- If hot water flows out of the drain pump, please wait until it cools down before opening it, and be careful not to get burned.
- It is recommended to clean the inlet valve filter every month, or when the error "E1" appears on the display.
- If Auto Dosing does not work properly, please check and clean the connection between the detergent drawer and the machine.
- Regular cleaning is needed to avoid unnecessary service and prolong the service life.

Freezing Handling

If the machine is frozen in a place below 0°C, please handle as follows.

1. Wrap the tap with a warm towel to help defrost, and soak the removed water inlet hose in warm water.
2. Pour warm water into the drum, close the door and let it inactive for 10 minutes, and then reconnect the water inlet hose to the tap to ensure normal use.

Notes concerning the energy and water consumption of the washing machine

- The most efficient programs in terms of energy consumption are generally those that perform at lower temperatures and longer durations.
- Program time as well as energy and water consumption depend on various factors, such as weight and type of the laundry, chosen functions, characteristics of the water etc.
- For only slightly or normally soiled laundry, decrease the temperature of the program, as the device uses less energy this way.
- Use the maximum spin speed available if the laundry will be dried afterwards, as the remaining moisture content will be lower, which in turn saves energy during the later drying process. Note, that noise and remaining moisture content are influenced by the spinning speed: the higher the spinning speed in the spinning phase, the higher the noise and the lower the remaining moisture content.
- Load the household washer-dryer up to the maximum capacity of each program to reduce the energy-and water consumption.

Specifications

Name	Washer Dryer
Model	WD10002RR4Z
Max Power	2000 W
Drying Power	1550 W
Rated Voltage	230 V~
Rated Frequency	50 Hz
Rated Volume	72 L
Waterproof Grade	IPX4
Net Weight/Gross Weight	83 kg / 89 kg
Dimensions*	595 (W) × 682 (D) × 850 (H) mm

* The distance from the rear panel of the machine to its front door (including the door).









• The program Eco 40-60 and Eco 40-60 Wash+Dry (cupboard) can be used to determine the values of the energy label according to (EU) 2019/2023.

Specifications

Fabric care chart



The following symbols provide garment care direction. The Clothing care labels include symbols for drying, bleaching, drying and ironing, or dry cleaning when necessary. The use of symbols ensures consistency among garment manufacturers of domestic and imported items. Follow care label directions to maximize garment life and reduce laundering problems.

Washing











	95 °C boil wash.
	60 °C coloured wash.
	60 °C coloured wash. ("Easy care" coloured wash)
	40 °C coloured wash.
	40 °C mild wash.
	40 °C very mild wash.
	30 °C fine wash.
	30 °C mild fine wash.
	30 °C very mild fine wash.
	Hand wash.
	Do not wash.

Note: The numbers in the wash tub specify the maximum washing temperatures in degrees Celsius which must not be exceeded.

Bleaching

	Any bleach allowed.
	Only oxygen bleach allowed.
	Do not bleach.

Drying





	Tumble drying / Drying at a temperature of 80 °C with a normal drying process.
	Tumble drying / Drying at a temperature of 60 °C with a mild drying process.
	Do not tumble dry
	Line drying.
	Drip line drying.
	Flat drying.
	Drip flat drying.
	Line drying in the shade.
	Drip line drying in the shade.
	Flat drying in the shade.
	Drip flat drying in the shade.

Notes:

- The dots indicate the drying level of the dryer.
- The lines indicate the type and place of the drying.









Specifications

Ironing

	Iron at maximum sole plate temperature of 200 °C.
	Iron at maximum sole plate temperature of 150 °C.
	Iron at maximum sole plate temperature of 110 °C. Caution when using steam irons (work without steam).
	Do not iron.

Note: The dots indicate the temperature ranges for ironing (regulator, steam, travel irons and ironing machines).

Professional care

	Professional dry-cleaning in perchloroethylene and/or hydrocarbons (heavy benzines) with normal process.
	Professional dry-cleaning in perchloroethylene and/or hydrocarbons (heavy benzines) with gentle process.
	Professional dry-cleaning in hydrocarbons (heavy benzines) with normal process.
	Professional dry-cleaning in hydrocarbons (heavy benzines) with gentle process.
	Do not dry-clean.
	Professional wet-cleaning.
	Mild professional wet-cleaning.
	Very mild professional wet-cleaning.
	Do not wet-clean.

Notes:

- The letters in a circle indicate the solvents (P, F) used in dry cleaning or wet cleaning (W).
- Generally, the line under the symbol indicates a milder treatment (e.g. gentle cycle for easy care items). The double line indicates care levels with particularly gentle treatment.

Indicative information

Cycles	Capacity (kg)	Program time (H:mm)	Energy Consumption (kWh/cycle)	Water Consumption (Litres/cycle)	Maximum Temperature (°C)	Remaining Moisture Content (%)	Spinning Speed (RPM)
ECO 40-60	10.0	3:59	0.855	64	42	53.5	1317
	5.0	2:55	0.608	49	31	53.5	1325
	2.5	2:36	0.212	39	21	54.0	1325
20 °C	5.0	1:34	0.258	58	20	55.0	1200
Cotton 60 °C	10.0	2:32	1.530	90	50	53.0	1400
Intensive 60 °C	5.0	2:29	1.051	77	56	55.0	1200
Synthetics 40 °C	4.0	1:58	0.640	55	36	35.0	1200
Wool 30 °C	2.0	0:49	0.400	50	26	35.0	800
Quick Cold	1.0	0:15	0.014	40	15	100.0	800
ECO 40-60 + Cupboard dry	6.0	8:35	4.520	100	30	-	1318
	3.0	6:35	2.620	65	22	-	1320

The values given for programmes other than the ECO 40-60 and Eco 40-60 Wash+Dry (cupboard) cycles are indicative only.

FAQ

Problem	Solution
<ul style="list-style-type: none"> Residual water in the drum before first use 	<ul style="list-style-type: none"> The machine has been tested with water injected before leaving the factory. Therefore, it is normal that water remains on the drum.
<ul style="list-style-type: none"> "Drum Clean" appears in the app when turning the machine on 	<ul style="list-style-type: none"> If you use the machine for a long time without running the "Drum Clean" program, a reminder will automatically appear in the app.
<ul style="list-style-type: none"> Smells 	<ul style="list-style-type: none"> There may be smells given off by rubber parts at first, but they will gradually disappear after the machine is used a few more times. Clean the gasket regularly. Run the "Drum Clean" program to keep the drum clean.
<ul style="list-style-type: none"> Water stains on the door glass 	<ul style="list-style-type: none"> The machine is subject to water-based tests before leaving the factory. It is normal that a small amount of water remains on the gasket and door glass. Water stains on the door glass due to splash during laundry can be cleaned as needed.
<ul style="list-style-type: none"> Buttons don't work 	<ul style="list-style-type: none"> The selected laundry mode does not support the program. The Child Lock feature is enabled, which is indicated by the Child Lock Lamp that stays on. Tap and hold the "Temp." and "Rinse" buttons to disable Child Lock.
<ul style="list-style-type: none"> No water refill 	<ul style="list-style-type: none"> This indicates low water pressure, which may be caused by a clogged inlet valve filter. It is recommended to clean the filter as instructed.
<ul style="list-style-type: none"> No spinning 	<ul style="list-style-type: none"> The drum is off-center because there is a single piece of clothing or a small number of heavy clothes in it. It is recommended to add more clothes.

Problem	Solution
<ul style="list-style-type: none"> Refilling and draining at the same time 	<ul style="list-style-type: none"> Do not remove the drain hose fixing buckle on the back of the body. Water drainage may occur when the machine is restarted. Check if the height of the drain hose is between 0.65m and 1.2m. Check if there is siphoning caused by the blocked drain hose or sewer.
<ul style="list-style-type: none"> Unable to see the water during washing 	<ul style="list-style-type: none"> The front-load machine is designed to save water, and the water levels for some programs are below the visible area from the glass door.
<ul style="list-style-type: none"> Too many or too few suds 	<ul style="list-style-type: none"> Adjust the amount of detergent used in the app. If there are too many suds, check the type of detergent. Only "low-sudsing" detergent is suitable for the front-load washer. If there are too few suds, there may be insufficient detergent in the detergent drawer. Please check and replenish it in time. If there are too few suds, the water level may be low in the laundry mode. It is recommended to observe the level during rinsing.
<ul style="list-style-type: none"> Difference between the displayed time and the actual running time 	<ul style="list-style-type: none"> There are several suds to eliminate. The drum is off-center, causing the running time to vary. The water pressure is low and the clothes absorb too much water, extending the water refilling time. The displayed time is an estimated time. The machine will intelligently adjust the time to the texture of the clothes and the selected program for the best result.

FAQ

Problem	Solution
<ul style="list-style-type: none"> The control panel is partially hot 	<ul style="list-style-type: none"> It is normal for electronic components to become slightly hot.
<ul style="list-style-type: none"> The upper cover of the machine is hot The door glass is hot 	<ul style="list-style-type: none"> During or at the end of drying, it is normal that these parts are hot.
<ul style="list-style-type: none"> Strange noise or excessive vibration of the body 	<ul style="list-style-type: none"> Check if all the transit bolts are removed. Check if the machine hits something. Check if the 4 feet of the machine are at the same level. Check if the clothes in the drum are placed evenly. Check if the clothes in the drum have metal parts like zippers that collide with the drum and make noises.
<ul style="list-style-type: none"> Strange noise from the drain pump 	<ul style="list-style-type: none"> Check if the filter element of the drain pump is blocked by dander. If so, clean it in time.
<ul style="list-style-type: none"> The door cannot be opened 	<ul style="list-style-type: none"> During program running, the door is locked, which is indicated by the Door Lock Lamp that stays on. When the water level or temperature is too high to open the door, the Door Lock Lamp will flash, with a beep as well as "Lock" and the remaining time will be displayed alternately on the screen. Child Lock is enabled.

Troubleshooting

If you fail to fix the problem, please turn off the power and water, and contact our after-sales customer service.

Error Code	Problem	Possible Cause	Solution
Unb	Spin error	<ul style="list-style-type: none"> The transit bolts are not removed. The feet of the machine are not on the same level. One single piece of or heavy clothing is washed or dried. Several or large clothes get tangled. There is a dry or spin error. 	<ul style="list-style-type: none"> Remove all the transit bolts. Adjust the feet of the machine to the same level. Increase or decrease the load size. Rearrange the clothes and then restart the machine.
E1	Refill error	<ul style="list-style-type: none"> The tap is turned off or there is a water outage. The inlet valve filter is clogged. The water inlet hose is frozen. 	<ul style="list-style-type: none"> Turn the tap on to see if the water supply is normal. Check and clean the inlet valve filter. Cover the water inlet hose with a warm towel to help defrost.
E2	Drain error	<ul style="list-style-type: none"> The drain hose opening is clogged by foreign objects. The drain valve is clogged by debris. The drain hose opening is at a high position. 	<ul style="list-style-type: none"> Remove foreign objects from the drain hose opening. Open the drain pump filter and remove the debris. Move the drain hose to a lower position.

Troubleshooting

Error Code	Problem	Possible Cause	Solution
E3	Door lock error	<ul style="list-style-type: none"> The door is not closed properly. Clothes may be caught in the door. 	<ul style="list-style-type: none"> Close the door again. Rearrange the clothes.
E4	Water level error	<ul style="list-style-type: none"> There is something wrong with the water level sensor. The water inlet valve is damaged. 	<ul style="list-style-type: none"> Restart the machine. If the problem persists, please contact Customer Service.
E5	Inverter error	<ul style="list-style-type: none"> There is something wrong with the inverter. 	<ul style="list-style-type: none"> Restart the machine. If the problem persists, please contact Customer Service.
E6	Heating error	<ul style="list-style-type: none"> The heating tube is loose or damaged. 	<ul style="list-style-type: none"> Please contact Customer Service.
E7	Temperature error	<ul style="list-style-type: none"> There is something wrong with the temperature sensor. 	<ul style="list-style-type: none"> Please contact Customer Service.
E10	Communication error	<ul style="list-style-type: none"> There is something wrong with the inverter communication. 	<ul style="list-style-type: none"> Restart the machine. If the problem persists, please contact Customer Service.

Error Code	Problem	Possible Cause	Solution
E11	Dry error	<ul style="list-style-type: none"> There is something wrong with the temperature sensor at the air inlet. 	<ul style="list-style-type: none"> Restart the machine. If the problem persists, please contact Customer Service.
E12	Dry error	<ul style="list-style-type: none"> There is something wrong with the temperature sensor at the air outlet. 	<ul style="list-style-type: none"> Restart the machine. If the problem persists, please contact Customer Service.
E14	Dry error	<ul style="list-style-type: none"> There is something wrong with the temperature sensor of the inlet condenser. 	<ul style="list-style-type: none"> Restart the machine. If the problem persists, please contact Customer Service.
E15	Dry error	<ul style="list-style-type: none"> There is something wrong with the heating element. There is something wrong with the turntable. 	<ul style="list-style-type: none"> Restart the machine. If the problem persists, please contact Customer Service.
E16	Dry error	<ul style="list-style-type: none"> There is something wrong with the drying fan. 	<ul style="list-style-type: none"> Restart the machine. If the problem persists, please contact Customer Service.

Troubleshooting

Error Code	Problem	Possible Cause	Solution
E17	Dry error	<ul style="list-style-type: none">• There is something wrong with the turntable.	<ul style="list-style-type: none">• Clean the inlet valve filter.• Turn the tap on to see if the water supply is normal. If the problem persists, please contact Customer Service.
E18	Dry error	<ul style="list-style-type: none">• There is something wrong with the regenerative fan.	<ul style="list-style-type: none">• Restart the machine. If the problem persists, please contact Customer Service.
Detergent lamp flashes	Detergent lamp keeps flashing	<ul style="list-style-type: none">• A reminder of detergent shortage.	<ul style="list-style-type: none">• Add detergent to the MAX line. If the lamp stays on, please contact Customer Service.
Softener lamp flashes	Softener lamp keeps flashing	<ul style="list-style-type: none">• A reminder of softener shortage.	<ul style="list-style-type: none">• Add softener to the MAX line. If the lamp stays on, please contact Customer Service.

Circuit Diagram

