

Roborock Dyad Pro

Wet and Dry Vacuum Cleaner User Manual

Read this manual carefully before using this product and store it properly for future reference.



English	03
Français	22
Español	41

Contents

04	Safety Information
06	International Symbols Explanation
07	FCC Statement
09	Product Introduction
10	Product Installation
11	Connecting to the App
12	Instructions for Use
17	Routine Maintenance
20	Basic Parameters
20	Holiday Energy Saving Function
21	Common Issues

Safety Information

IMPORTANT SAFETY INSTRUCTIONS

When using an electrical appliance, basic precautions should always be followed, including the following:

- READ ALL INSTRUCTIONS BEFORE USING (THIS APPLIANCE).
- Failure to follow the warnings and instructions may result in electric shock, fire and/or serious injury.

WARNING

To reduce the risk of fire, electric shock or injury:

- Do not use outdoors or on wet surfaces when charging. Store indoors. Use indoor only.
- Do not allow to be used as a toy. Close attention is necessary when used by or near children, pets or plants.
- Use only as described in this manual. Use only manufacturer's recommended attachments.
- Use the maintenance brush carefully to avoid injury. Keep out of reach of children.
- Do not use with damaged cord or plug. If appliance is not working as it should, has been dropped, damaged, left outdoors, or dropped into water, return it to a service center.
- Do not pull or carry by cord, use cord as a handle, close a door on cord, or pull cord around sharp edges or corners. Do not run appliance over cord. Keep cord away from heated surfaces.
- Do not unplug by pulling on cord. To unplug, grasp the plug, not the cord.
- Do not handle Power Supply, including Power Supply plug, and Power Supply terminals with wet hands.
- Do not put any object into openings. Do not use with any opening blocked; keep free of dust, lint, hair, and anything that may reduce air flow.
- Do not immerse. Use only on carpet moistened by cleaning process.
- Brush may start unexpectedly. To reduce the risk of injury from moving parts, keep the power off before cleaning or servicing.
- Keep hair, loose clothing, fingers, and all parts of body away from openings and moving parts.
- Use extra care when cleaning on stairs.
- Do not use to pick up flammable or combustible liquids, such as gasoline, or use in areas where they may be present.
- Do not pick up anything that is burning or smoking, such as cigarettes, matches, or hot ashes.
- Prevent unintentional starting. Ensure the switch is in the off-position before picking up or carrying the appliance. Carrying the appliance with your finger on the switch or energizing appliance that have the switch on invites accidents.
- Recharge only with the Power Supply specified by the manufacturer. A Power Supply that is suitable for one type of battery pack may create a risk of fire when used with another battery pack.

Safety Information

- Use appliances only with specifically designated battery packs. Use of any other battery packs may create a risk of injury and fire.
- When battery pack is not in use, keep it away from other metal objects, like paper clips, coins, keys, nails, screws or other small metal objects, that can make a connection from one terminal to another. Shorting the battery terminals together may cause burns or a fire.
- Under abusive conditions, liquid may be ejected from the battery; avoid contact. If contact accidentally occurs, flush with water. If liquid contacts eyes, additionally seek medical help. Liquid ejected from the battery may cause irritation or burns.
- Do not use a battery pack or appliance that is damaged or modified. Damaged or modified batteries may exhibit unpredictable behavior resulting in fire, explosion or risk of injury.
- Do not expose a battery pack or appliance to fire or excessive temperature. Exposure to fire or temperature above 130°C (266 °F) may cause explosion.
- Follow all charging instructions and do not charge the battery pack or appliance outside of the temperature range specified in the instructions. Charging improperly or at temperatures outside of the specified range may damage the battery and increase the risk of fire.
- Have servicing performed by a qualified repair person using only identical replacement parts. This will ensure that the safety of the product is maintained.
- Do not modify or attempt to repair the appliance or the battery pack except as indicated in the instructions for use and care.
- Always turn off this appliance before connecting or disconnecting motorized nozzle.
- Do not use without filters in place.
- Do not use a flammable or combustible liquid to clean a floor.

SAVE THESE INSTRUCTIONS

Household use only.

Safety Information

Battery and Charging

- Please keep the power supply and docking station away from heat (such as heating plates).
- For connection to a supply not in the U.S.A., use an attachment plug adapter of the proper configuration for the power outlet, if needed.
- The battery must be removed from the appliance before it is scrapped.
- The appliance must be disconnected from the supply mains when removing the battery.
- The battery is to be disposed of safely. Please do not discard waste batteries. Leave them to a professional recycling organization.
- Do not wipe or clean the power supply or docking station shrapnel with a piece of wet cloth or wet hands.
- Please make sure the cleaner is powered off in shipment and original packaging is advised.
- If left unused for a long period, please store the cleaner in a cool and dry place after having it fully charged and switched off, charge it at least every three months to avoid the battery being over discharged.
- Please do not use the product when the temperature is higher than 40°C (104°F) or lower than 4°C (39°F), or there is any liquid or sticky substance on the floor.

Battery pack charging temperature		4°C ~ 40°C (39 ~ 104°F)
Battery pack using temperature		4°C ~ 40°C (39 ~ 104°F)
Battery pack storage temperature	Storage(within 3 months)	-20°C ~ 45°C (-4 ~ 113 °F)@Less than 75% RH
	Long Storage(3months)	25+/- 3°C (77 °F +/- 37.4 °F)@Less than 75% RH

International Symbols Explanation

Ⓞ – ON-OFF (push-push) symbol [symbol IEC 60417-5010 (2009-02)]

~ – ALTERNATING CURRENT symbol [symbol IEC 60417-5032 (2009-02)]

≡ – DIRECT CURRENT symbol [symbol IEC 60417-5031 (2009-02)]

FCC Statement

Compliance Information	
Product Name	Wet and Dry Vacuum Cleaner and Accessories
Product Model	Wet and Dry Vacuum Cleaner Model: WD2H1A Power Supply Model: YJS060P-3001900U, E060-1P300190VU
Compliance Statement	This device complies with part 15 of the FCC Rules. Operation is subject to the following two conditions: (1) This device may not cause harmful interference, and (2) this device must accept any interference received, including inter-ference that may cause undesired operation.
Correspondence of the responsible party in USA	
Company	Roborock Technology Co.
Address	ROOM 1227, 12TH FLOOR, 1000 N. WEST STREET, WILMINGTON, DE 19801
Email	support@roborock.com

FCC Statement

Warning

Any changes or modifications to this unit not expressly approved by the party responsible for compliance could void the user's authority to operate the equipment.

Note: This equipment has been tested and found to comply with the limits for a Class B digital device, pursuant to part 15 of the FCC Rules. These limits are designed to provide reasonable protection against harmful interference in a residential installation. This equipment generates, uses and can radiate radio frequency energy and, if not installed and used in accordance with the instructions, may cause harmful interference to radio communications. However, there is no guarantee that interference will not occur in a particular installation. If this equipment does cause harmful interference to radio or television reception, which can be determined by turning the equipment off and on, the user is encouraged to try to correct the interference by one or more of the following measures:

- Reorient or relocate the receiving antenna.
- Increase the separation between the equipment and receiver.
- Connect the equipment into an outlet on a circuit different from that to which the receiver is connected.
- Consult the dealer or an experienced radio/TV technician for help.

IC Statement

This device contains licence-exempt transmitter(s)/receiver(s) that comply with innovation, Science and Economic Development Canada's licence-exempt RSS(s). Operation is subject to the following two conditions:

(1) This device may not cause interference, and (2) This device must accept any interference, including interference that may cause undesired operation of the device.

L'émetteur/récepteur exempt de licence contenu dans le présent appareil est conforme aux CNR d'Innovation, Sciences et Développement économique Canada applicables aux appareils radio exempts de licence. L'exploitation est autorisée aux deux conditions suivantes :

- (1) L'appareil ne doit pas produire de brouillage;
- (2) L'appareil doit accepter tout brouillage radioélectrique subi, même si le brouillage est susceptible d'en compromettre le fonctionnement.

MPE Requirements

To satisfy FCC / IC RF exposure requirements, a separation distance of 20 cm or more should be maintained between the antenna of this device and persons during device operation. To ensure compliance, operations at closer than this distance is not recommended.

CAN ICES-3 (B)/NMB-3(B)

Product Introduction

Vacuum Cleaner

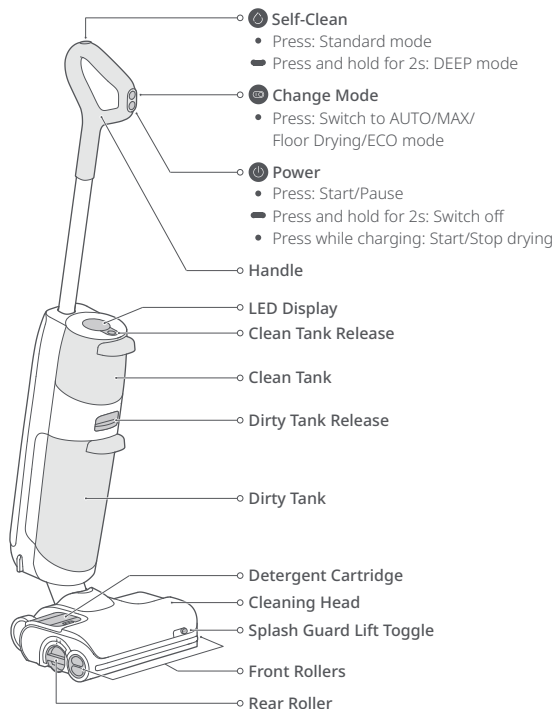

Accessories

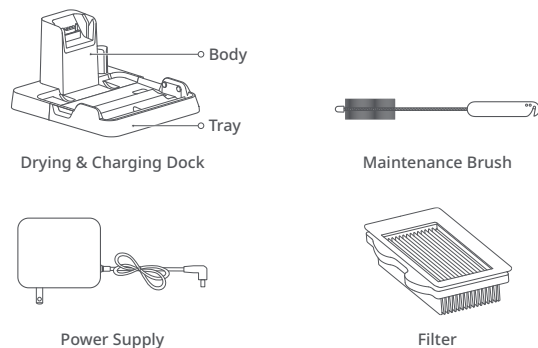

Screen Functions

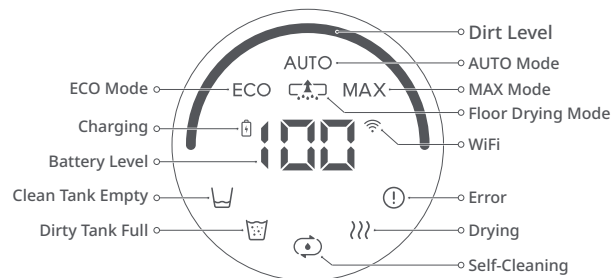

Product Installation

Setting Up the Vacuum Cleaner

1. Insert the handle into the vacuum body until it clicks in place. The power button should face forwards.
2. To remove the handle, remove the clean tank and then gently pull the handle while pressing the release button on the vacuum body.

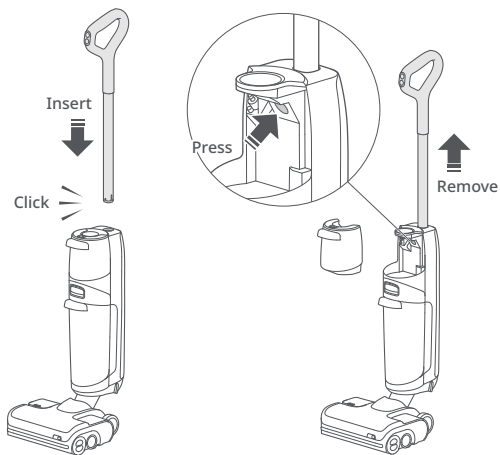

Charging Dock Installation

1. Align the charging dock tray with the charging dock body, press down, making sure they are firmly secured.

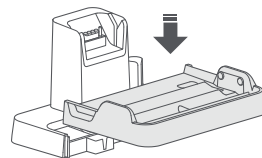

2. Connect the power supply into the bottom of the charging dock and plug it in. Power cable can exit from the side.

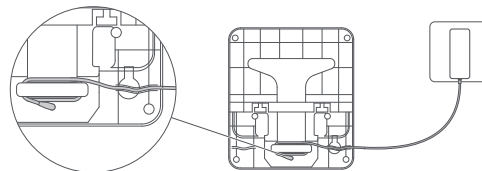

3. To disassemble the charging dock, grasp the side handles of the tray and pull upward.

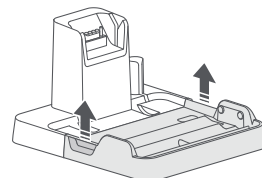



Connecting to the App

1. Download the App.

Search "Roborock" in the App Store or Google Play or scan the QR code below to download and install the app.



2. Reset WiFi.

- Keep the machine upright and press  to light up the screen and enter standby mode.
- Press and hold  and  until you hear the "Resetting WiFi" voice alert. The reset is complete when the WiFi indicator flashes slowly. The vacuum cleaner will then wait for a connection.

Press and hold the buttons simultaneously



WiFi Indicator

- Off: WiFi disabled
- Flashing slowly: Waiting for connection
- Flashing quickly: Connecting
- Steady on: WiFi connected

Note: If the mobile phone fails to connect to the vacuum cleaner because your router configuration has changed or you forget your password or for any other reasons, reset WiFi and add your device again.

3. Add the Device.

On the Roborock App, tap "+" on the home page, and add the device as instructed in the app.

Notes:

- The actual process may vary due to ongoing app updates. Follow the instructions provided in the app.
- Only 2.4 GHz WiFi is supported.
- If the vacuum cleaner waits more than half an hour for a connection, WiFi will be automatically disabled. If you want to reconnect, reset the WiFi before proceeding.

Instructions for Use

Filling the Clean Tank

1. Push the Clean Tank Release and remove the tank.
2. Open the plug, fill it with tap water, and then close it tightly. The water level should not exceed the MAX line.

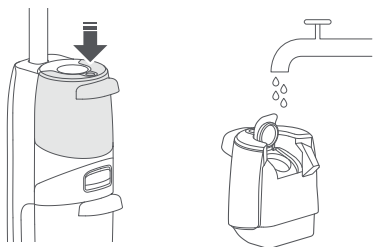

3. Reinstall the Clean Tank bottom first then push forward to secure it in place.



Note: To avoid deforming the Clean Tank, only use cold water.

Adding Detergent

1. Push the detergent cartridge release button and remove the cartridge.

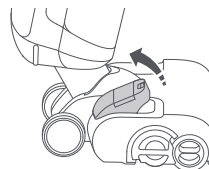

2. Open the detergent cartridge, fill it with detergent, and then close it tightly.



3. Reinstall the detergent cartridge.

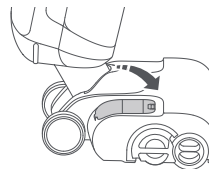

Notes:

- The detergent cartridge requires refilling after about 20 tanks of clean water.
- Remove the detergent cartridge if it is deemed unnecessary.
- To prevent corrosion or damage, only use detergent recommended by Roborock.

Instructions for Use

Locking and Unlocking

Tap the side of the cleaning head without the detergent cartridge, and push the handle to lock the cleaning head or pull the handle to unlock the cleaning head.

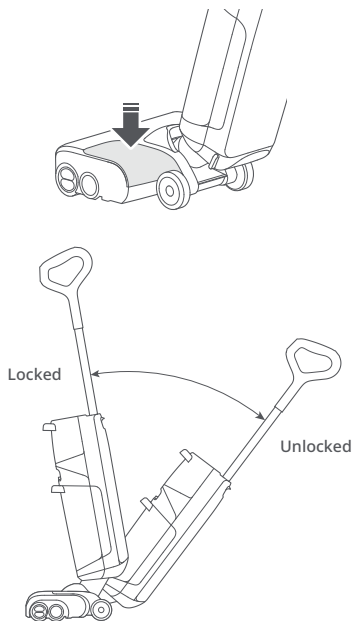

Starting the Vacuum Cleaner

Unlock the cleaning head, tilt the body and press the power button to start the vacuum cleaner.

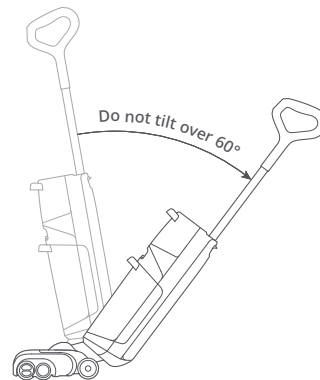

Caution: In order to prevent dirty water from leaking out, do not lay the body flat or tilt it over 60° when dirty tank is in place.

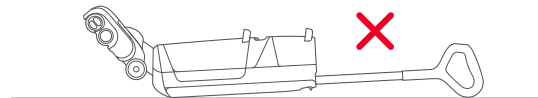

Notes:

- The cleaning head does not work when locked. Unlock it first.
- Press power button can only start drying when the vacuum cleaner is charging.

Instructions for Use

Switching Modes

Press the change mode button to switch between AUTO, MAX, Floor Drying and ECO modes. The screen will display the icon for the current mode.



Notes:

- Floor Drying mode is for removing clean water from wet environments such as bathrooms. It should not be used when water depth exceeds 10mm (0.4in).
- Floor Drying mode is limited to one minute. After which, AUTO mode will resume.

Adjusting the Splash Guard

You can adjust the splash guard using the lift toggle. You can raise it to collect large pieces of waste on the floor and lower it to prevent the cleaning head from getting stuck when there are many objects on the floor.

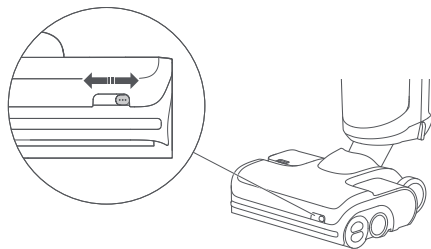

Standby and Power Off

1. When the vacuum cleaner is operating, press the power button to pause it and enter standby mode.
2. In standby mode, you can lock the cleaning head and place the vacuum cleaner upright on the floor.
3. Lock the cleaning head and press and hold the power button for 2 seconds to turn off the vacuum cleaner. If the vacuum cleaner is left idle for 5 minutes in standby mode, it will automatically turn off.

Note: You can modify the settings in the app to enable automatically resume operation after unlocking the cleaning head.

Instructions for Use

Adding and Emptying Water

When the dirty tank is full or the clean tank is empty during use, the vacuum cleaner will provide audio and visual alerts. Add water into the clean tank or empty the dirty tank before continuing.

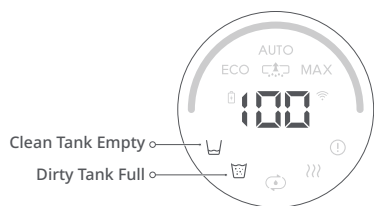

Emptying the Dirty Tank

1. Push the dirty tank release and remove the tank.
2. Hold the handle firmly with one hand, and gently lift out the cover.

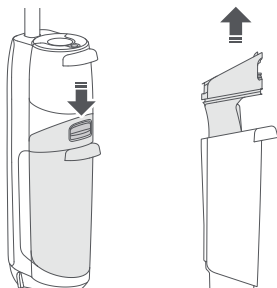

3. Pour out the dirty water. If there is any solid dirt in the tank, filter it using the filter at the bottom of the cover.

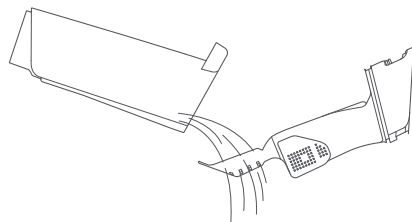

4. Reinstall the cover, tilt the dirty tank, install the bottom in place, and then gently push it inward to secure it in place.

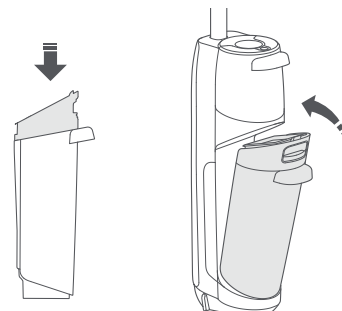

Instructions for Use

Charging and Self-Cleaning

1. Lock the cleaning head, and place the vacuum cleaner onto the charging dock. The voice alert "Charging" indicates that the vacuum cleaner is charging.
2. Press the Self-Clean button to start standard self-cleaning. Press and hold the clean button for 2 seconds to switch to DEEP self-cleaning mode.
3. After self-cleaning finishes, empty the dirty tank to prevent odor.



Notes:

- The product is equipped with a built-in high-performance lithium-ion rechargeable battery pack. To maintain battery performance, keep the product charged for normal use.
- Always place the vacuum cleaner on the charging dock after use to prevent water stains.

Drying

Drying starts automatically after self-cleaning is completed. To manually start or stop drying, press the power button on the docked vacuum cleaner.

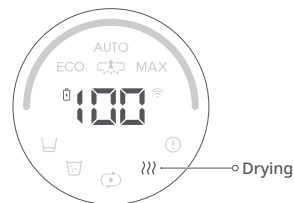

Voice Alert Settings

Connect to the app to adjust the volume of voice alerts.

Routine Maintenance

To maintain optimal performance of the product, refer to the following table for routine maintenance.

Parts	Maintenance Frequency	Replacement Frequency
Roller	2-4 weeks	6-12 months
Filter	1 month	6-12 months
Cleaning head and dirty water pipe	1 month	N/A
Dirty tank	1 month	N/A
Dirty water level sensor	1 month	N/A
Charging dock tray	As needed	N/A
Charging contact	1 month	N/A

Product Maintenance

If this product is left unused for a prolonged period of time, fully charge it and unplug it before storing it in a cool and dry place. Do not place the product in humid locations or under direct sunlight. Charge it at least once every 3 months to avoid overdischarge.

Cleaning the Body

Wipe and clean the body with a soft and dry cloth. Before cleaning, unplug the power supply and keep the vacuum cleaner off.

Cleaning the Dirty Tank and Filter

1. Take out the dirty tank, pull out the cover, and open the water level sensors. Clean the parts with the provided maintenance brush, rinse them with cold water, and then snap the water level sensors back in place.

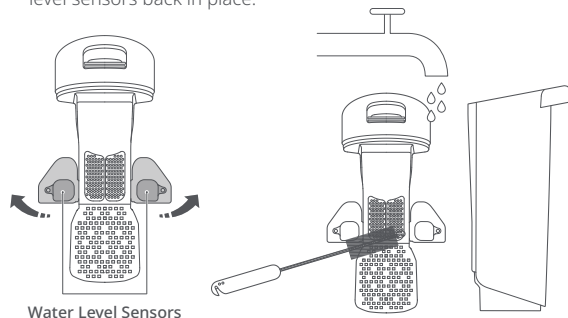

Water Level Sensors

2. Take out the filter from dirty water tank cover and remove any trash attached to the filter. If the filter is dirty, rinse it with cold water and then shake off the residual water.

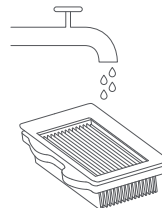

Routine Maintenance

3. Allow up to 24 hours for all parts drying and install them back in place.

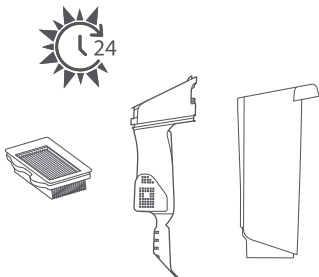

Notes:

- Use a second filter if necessary.
- Do not touch the filter with your hands, brushes, or sharp objects to avoid damage to the filter.

Cleaning the Rollers

1. Remove the vacuum cleaner from the charging dock, switch it off.
2. Place the vacuum on a hard and flat floor and lock the cleaning head.
3. Rotate the rear roller cover to the unlock position, and pull the rear roller outward.

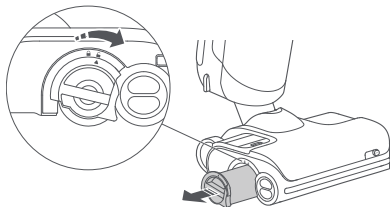

4. Pinch the left and right front rollers with both hands, and pull them outward.

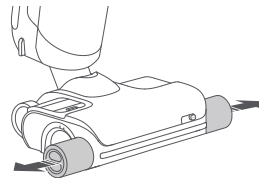

5. Cut off any hair entangled on the rollers and remove any debris using the provided maintenance brush.

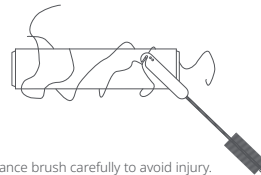

Note: Use the maintenance brush carefully to avoid injury.

6. Insert the rear roller from the side, and then rotate the rear roller cover from the unlock position to the lock position until it clicks in place.

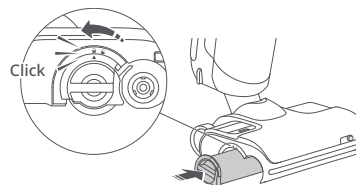

Routine Maintenance

7. To install the front rollers, marked red and blue, on the correct sides of the head. Pinch them with both hands and align them with the front roller shaft. Push inward to install properly.

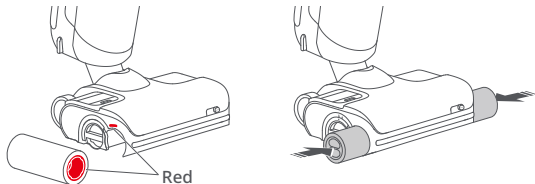

Cleaning the Cleaning Head and Dirty Water Pipe

1. Remove the dirty tank and front and rear rollers. Switch it off and stabilize the body.
2. Clean the roller slots and dirty water pipe with the maintenance brush provided.
3. Wipe the charging contacts with a dry cloth.
4. Reinstall the rollers and dirty tank in place.

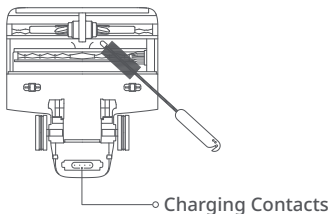

Note: Do not wash the cleaning head directly with water.

Cleaning the Charging Dock Tray

1. Grasp the side handles of the tray and pull upward.

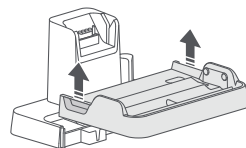

2. Rinse the tray with water and reinstall it in place after drying.

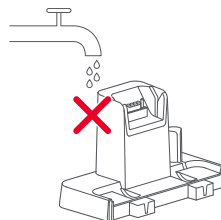
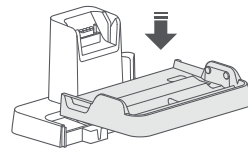
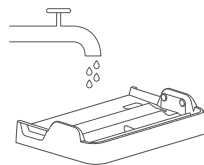

Note: Only remove and wash the tray. Do not wash any other parts of the charging dock.

Basic Parameters

Body

Model	WD2H1A
Weight	4.8 kg
Rated power	260 W
Rated voltage	21.6 V $\overline{\text{---}}$
Charging time	< 4 hours
Battery	21.6 V/4000 mAh (TYP) Lithium-ion battery

Power Supply

Model	YJS060P-3001900U, E060-1P300190VU
Rated input	100-240 V~ 50-60 Hz, 1.5 A
Rated output	30 V $\overline{\text{---}}$ 1.9 A
Battery	21.6 V/4000 mAh (TYP) Lithium-ion battery

Holiday Energy Saving Function

Turn off the device, press and hold "Change Mode" button, put the device back to the dock and wait for 10 seconds until you hear a voice alert then release the button. This will activate Holiday mode.

In this mode the device will switch to Low Power mode to minimize power consumption. This includes a dimming of the LED indicator, and the stopping of all non-charging related functions including cleaning, remote control over WiFi, and more.

To deactivate Holiday mode, remove the vacuum cleaner from the charging dock, press and hold "Power" for 10 seconds and press "Power" again. Screen has brightened and the vacuum cleaner has exited Holiday mode.

Common Issues

Issue	Solution
There are large water stains on the floor, the cleaning head leaks water, or water cannot be vacuumed from the floor.	<ul style="list-style-type: none">Remove the rollers and the dirty tank to check for a clog in the dirty water pipe or the suction outlet, and if the filter is clogged. Clear all blockages, clean the filter and make sure dirty tank and filter were properly installed before retrying.
The screen does not light up and the vacuum cleaner cannot start.	<ul style="list-style-type: none">Low battery level. Charge it before use.
The dirty tank leaks and the filter is wet.	<ul style="list-style-type: none">Remove and clean the two water level sensors in the dirty tank. Make sure that the body is not laid flat.
There is a strange smell during use.	<ul style="list-style-type: none">Clean the rollers, dirty tank, and filter.
Cleaning creates a lot of bubbles.	<ul style="list-style-type: none">Do not add detergent or disinfectants that are not recommended by Roborock to the clean tank, or spray such detergent or disinfectants on the floor.
The vacuum cleaner does not charge when docked.	<ul style="list-style-type: none">Check the charging contacts on the charging dock and the corresponding part on the body.
The screen is on, but the buttons do not respond.	<ul style="list-style-type: none">Press and hold the power button for 10 seconds to force restart the vacuum cleaner.
Unable to connect to WiFi.	<ul style="list-style-type: none">WiFi disabled. Reset the WiFi and try again.Poor WiFi signal. Move the vacuum cleaner to an area with good WiFi reception.Abnormal WiFi connection. Reset the WiFi, download the latest mobile app and retry.Unable to connect to WiFi. There may be an error with your router settings. Contact Roborock Customer Service for help with troubleshooting.
Is power always being drawn when the vacuum cleaner is on the dock?	<ul style="list-style-type: none">The vacuum cleaner will draw power while it is docked to maintain battery performance, but the power consumption is extremely low.